

INVESTMENT OPPORTUNITIES

# Strategic Industrial Zones for your Business in the Czech Republic

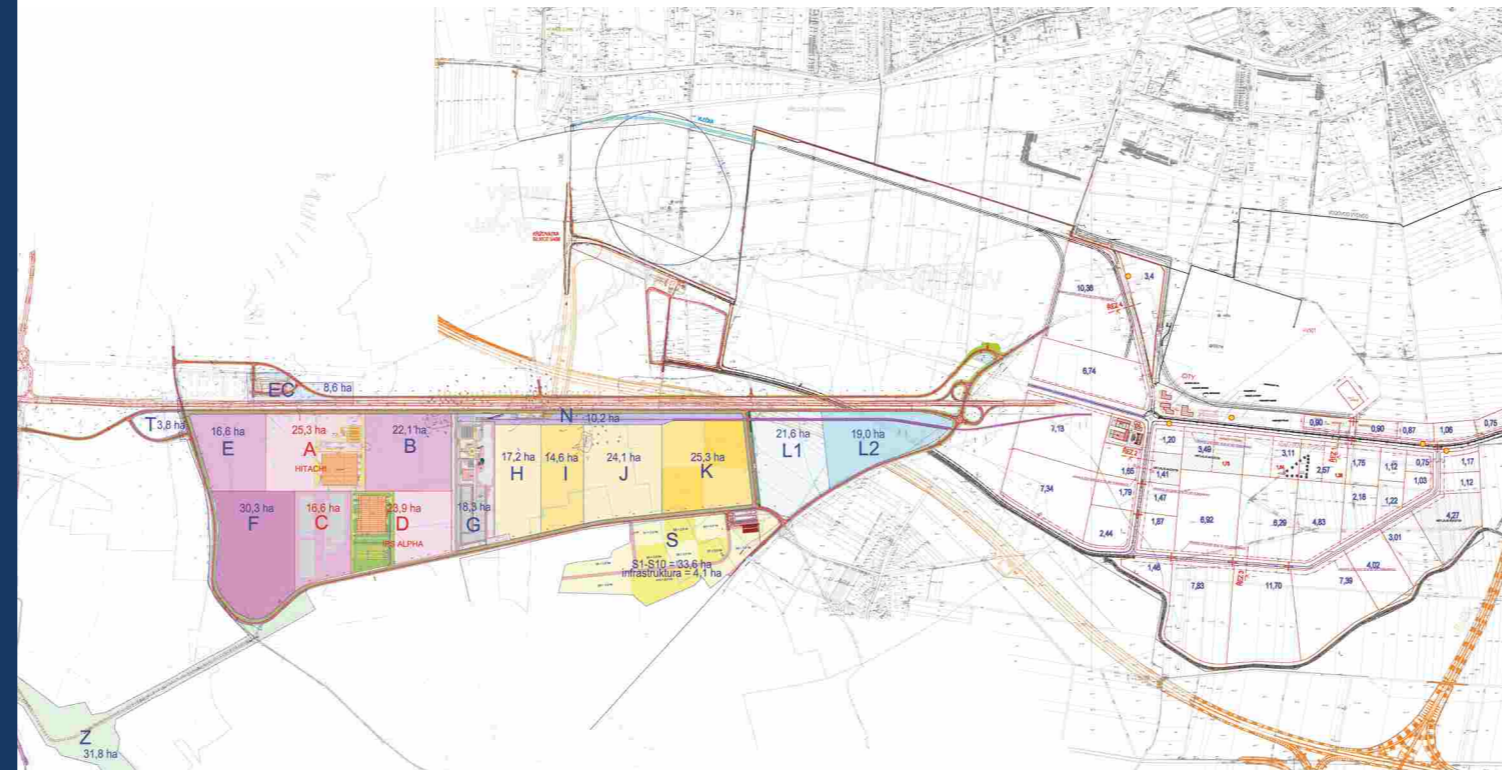

## FUNDING PROGRAMMES ADMINISTERED BY CZECHINVEST

Source of funding	Type of activity	Funding programme	Type and amount of incentive		Eligible costs	
			New manufacturing investors	Existing manufacturing firms		
State incentive programme	Production activities (establishment of a new or expansion of an existing production facility)	National incentives (Action Investment Incentives)	Full tax relief for five years, Job-creation grants, Training grants	Partial tax relief for five years, Job-creation grants, Training grants	Investment costs, i.e. purchase price of land, buildings, new machinery and intangible assets	
		Innovation (EU funding programme OPP)	-	Subsidy CZK 1-150 million Max. 40% of eligible costs	Investment costs, i.e. purchase price of fixed assets	
	Innovations (purchase of new or modernisation of existing technology/ to produce an "innovated product")	Potential (EU funding programme OPP)	-	Subsidy CZK 1-200 million Max. 40% of eligible costs	Subsidy CZK 1-200 million Max. 40% of eligible costs	Investment costs, i.e. purchase price of land, buildings, new machinery, intangible assets and other necessary equipment
		R&D activities (Industrial R&D)	-	Subsidy CZK 1.5-150 million Max. 40% of eligible costs	Subsidy CZK 1.5-150 million Max. 40% of eligible costs	Investment costs, i.e. purchase price of land, buildings, new machinery, intangible assets and other necessary equipment
European Union structural funds	IT and software development activities	ICT and Business Support Services (EU funding programme OPP)	Shared services	-	Gross wages of new employees (including social-security and health insurance) <b>PLUS</b> Real estate rental in the case of both options	
			Repair activities (high-tech repair centres)	Subsidy CZK 0.5-8 million Max. 25% of eligible costs	Subsidy CZK 0.2-100 million Max. 40% of eligible costs	Travel, dining, accommodation of trainers and employees in training, personnel costs and direct support of training participants, administrative and overhead costs, etc.
	Training of employees (both internal and external)	EDUCA (Global EU grant)	Subsidy CZK 0.5-8 million Max. 25% of eligible costs	Subsidy CZK 0.5-8 million Max. 25% of eligible costs	Purchase or modification of real estate, construction or renovation of buildings, training aids, equipment and software	
		Training Centres (EU funding programme OPP)	-	Subsidy CZK 0.2-100 million Max. 40% of eligible costs	Project preparation, purchase price of real estate, utilities networks, land preparation, renovation of business property	
Construction of a training centre (construction of a new or renovation of an existing building, purchase of equipment)	Renovation of a building (e.g. a brownfield) (conversion of a building into a business facility and project documentation)	Real Estate (EU funding programme OPP)	Energy savings in factory buildings	Subsidy CZK 0.5-500 million Max. 40% of eligible costs	Engineering works under construction, renovation/modernisation (technical improvement) of structures, hardware and networks, machinery and equipment, including control software	
			Energy savings in factory buildings	-	Subsidy CZK 0.5-250 million Max. 40% out of eligible costs	

**CZECHINVEST HEADQUARTERS**

PHONE: +420 296 342 500  
FAX: +420 296 342 502  
E-MAIL: fdi@czechinvest.org  
WEB: www.czechinvest.org

Stepanska 15, 120 00 Prague 2  
Czech Republic

[www.czechinvest.org](http://www.czechinvest.org)



This material is distributed free of charge.



**Region:** Ústí  
**Total area:** 175 ha  
**Available area:** 129 ha  
**Price:** Information available upon request

Workforce	Districts	Unemployment rate
Most	59,980	15.7%
Chomutov	70,114	12.5%
Louny	50,800	11.7%
Teplice	62,692	13.5%
<b>Total/Average</b>	<b>243,586</b>	<b>13.4%</b>

Source: Ministry of Labour and Social Affairs, May 2010

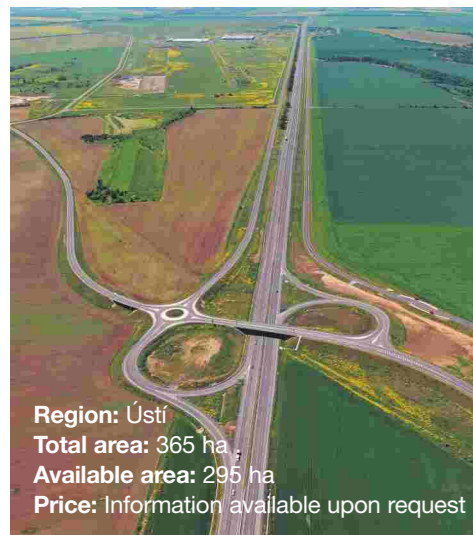

**Region:** Ústí  
**Total area:** 365 ha  
**Available area:** 295 ha  
**Price:** Information available upon request

Workforce	Districts	Unemployment rate
Most	59,980	15.7%
Chomutov	70,114	12.5%
Louny	50,800	11.7%
<b>Total/Average</b>	<b>180,894</b>	<b>13.3%</b>

Source: Ministry of Labour and Social Affairs, May 2010

## Joseph Strategic Industrial Zone, Most

The Joseph Strategic Industrial Zone is located eight kilometers southwest of the city of Most. The area itself is adjacent to the first-class I/27 Most – Žatec – Plzeň state road. A motorway and expressway on the Slaný – Chemnitz (R7) and Lovosice – Dresden (D8) routes are being constructed in the area around Most, which will eventually be connected to the international motorway network. Land plots are available for sale its sizes starting at 2 ha. The Most-Velebudice Technical Secondary School is implementing the “Educational and Training Centre of the Ústí Region” project, under the name “POLYGON” in its classrooms, which is intended for training employees of industrial enterprises in the Ústí region. Within this project the preparation of skilled workers will be arranged in close cooperation with partners and will reflect such partners’ needs and demands to the maximum possible extent.

**Investors located in the zone:**  
 Nemak Czech Republic, Starcam, RAI Most, AFSI Europe

Region	Students	Graduates	Programmes	Schools
Ústí	24,699	5,066	456	80

**Selected companies in the district, ranked by turnover:**  
 Unipetrol RPA, s.r.o., Litvínov - Záluží/Aerosols and chemicals in disc form; Petroleum gases and other gaseous hydrocarbons, except natural gas; Plastics in primary forms  
 Severočeské doly, a.s., Chomutov/Mining of brown coal  
 AGC Flat Glass Czech a.s., a member of AGC, Teplice - Řetenice/Manufacture of flat glass  
 Grammer CZ, s.r.o., Most - Velebudice/Manufacture of other parts and accessories for motor vehicles  
 Sandvik Chomutov Precision Tubes, s.r.o., Chomutov/Manufacture of steel tubes, pipes, hollow profiles and related fittings  
 Kyocera Solar Europe, s.r.o., Kadaň/Manufacture of electronic components  
 Lostr, a.s., Louny/Manufacture of railway locomotives and rolling stock  
 Toyota Gosei Czech, s.r.o., Klášterec nad Ohří - Vernéřov/Manufacture of parts and accessories for motor vehicles  
 FTE automotive Czechia, s.r.o., Podbořany/Manufacture of motor vehicles  
 Koito Czech, s.r.o., Žatec/Manufacture of electrical and electronic equipment for motor vehicles

Source: CreditInfo, Company Monitor, 2010

## Strategic Industrial Zone Triangle, Žatec

The Triangle Strategic Industrial Zone is situated at the border of three districts: Chomutov, Most and Louny. From the transportation perspective, the zone is very well accessible since it is located at the former Žatec military airport. The site adjacent to the I/7 arterial road on the Prague – Chomutov – Hora Sv. Sebestiána/Reitzenhain (FRG) route (to become the R7 expressway); another arterial road, the I/27 (Most – Žatec – Plzeň) is roughly one kilometer from the site. The Most-Velebudice Technical Secondary School is implementing the “Educational and Training Centre of the Ústí Region”, under the name “POLYGON” in its classrooms, which is intended for training employees of industrial enterprises in the Ústí region. Within this project the preparation of skilled workers will be arranged in close cooperation with partners and will reflect such partners’ needs and demands to the maximum possible extent.

**Investors located in the zone:**  
 IPS Alpha Technology Europe, Solar Turbines, Panasonic AVC Networks

Region	Students	Graduates	Programmes	Schools
Ústí	24,699	5,066	456	80

**Selected companies in the district, ranked by turnover:**  
 Unipetrol RPA, s.r.o., Litvínov - Záluží/Aerosols and chemicals in disc form; petroleum gases and other gaseous hydrocarbons, except natural gas; plastics in primary forms  
 ČESKÁ RAFINÉRSKÁ, a.s., Litvínov - Záluží/Manufacture of refined petroleum products  
 Grammer CZ, s.r.o., Most - Velebudice/Manufacture of other parts and accessories for motor vehicles  
 Sandvik Chomutov Precision Tubes, s.r.o., Chomutov/Manufacture of tubes, pipes, hollow profiles and related fittings  
 Kyocera Solar Europe, s.r.o., Kadaň/Manufacture of electronic components  
 Lostr, a.s., Louny/Manufacture of railway locomotives and rolling stock  
 Toyota Gosei Czech, s.r.o., Klášterec nad Ohří - Vernéřov/Manufacture of parts and accessories for motor vehicles  
 FTE automotive Czechia, s.r.o., Podbořany/Manufacture of motor vehicles  
 Sanko Nederland B. V., organisation unit, Korozluky/Manufacture of rubber products  
 Parker Hannifin Industrial, s.r.o., Chomutov/Manufacture of other pumps and compressors

Source: CreditInfo, Company Monitor, 2010

— Existing expressways — Existing motorways — Planned expressways — Planned motorways

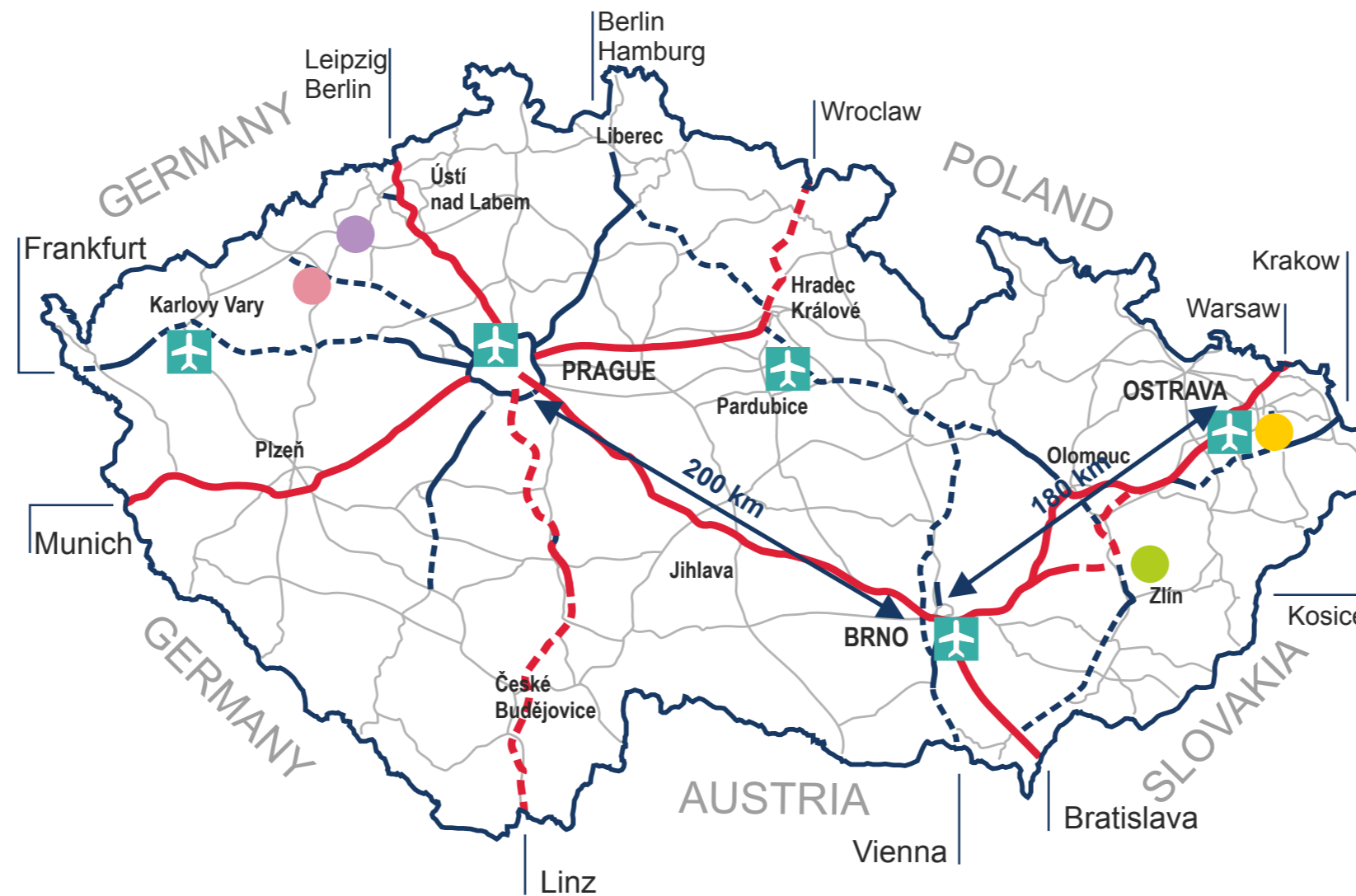

Distance (km)	Holešov	Mošnov	Triangle	Most
Hamburg	920	830	620	590
Berlin	635	555	330	305
Leipzig	540	580	235	210
Dresden	435	475	130	100
Frankfurt	790	865	490	490
Munich	660	735	365	445
Linz	370	545	330	335
Vienna	220	295	430	445
Bratislava	190	250	420	430
Košice	365	350	750	760
Krakow	260	190	655	630
Warsaw	480	390	750	720
Wroclaw	290	225	400	380

**CzechInvest operates two databases:**

The database of business properties is not a public listing of available business properties in the Czech Republic. Based on this information, CzechInvest can create a selection of properties according to your needs.

The National Brownfields Database offers sites prepared to suit the plans of investors. The database contains information for the preparation of future projects and documents pertaining to the revitalisation of brownfield sites.

Secondary school Field	Students	Graduates	Programmes
Technical	24,293	5,241	442
applicable to aerospace	561	0	6
applicable to automotive	10,165	2,046	211
Eco/Finance/Business	90,421	22,514	1,515
Cleantech	2,584	588	44
Medicine/Pharmacy	14,419	3,502	134
Chemistry	3,499	898	96
Electronic/ICT	33,535	7,226	536
Others fields	134,165	24,343	2,220
<b>Total</b>	<b>296,883</b>	<b>66,358</b>	<b>5,204</b>

Universities Priority sectors	Students	Graduates
Electro	6,930	2,079
Economics	98,075	22,282
Technical	17,373	3,239
Cleantech	8,539	1,825
ICT	32,789	6,575
Pharmacy	2,124	344
Medicine	32,557	5,914
Chemistry	8,701	1,901
Nanotechnology	189	8
Aerospace	789	253
<b>Total Czech Republic</b>	<b>389,231</b>	<b>81,672</b>



**Region:** Moravia-Silesia  
**Total area:** 200 ha  
**Available area:** 72 ha  
**Price:** Information available upon request

Workforce	Districts	Unemployment rate
Nový Jičín	78,220	11.4%
Ostrava	176,199	11.6%
<b>Total/Average</b>	<b>254,419</b>	<b>11.5%</b>

Source: Ministry of Labour and Social Affairs, May 2010

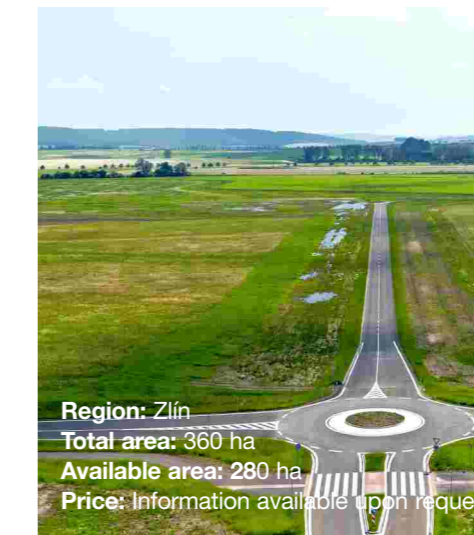

**Region:** Zlín  
**Total area:** 360 ha  
**Available area:** 280 ha  
**Price:** Information available upon request

Workforce	Districts	Unemployment rate
Kroměříž	51,868	11.9%
Uherské Hradiště	74,733	9.2%
Vsetín	77,752	10.8%
Zlín	100,130	9.3%
Přerov	71,154	11.3%
<b>Total/Average</b>	<b>375,637</b>	<b>10.5%</b>

Source: Ministry of Labour and Social Affairs, May 2010

## Strategic Industrial Zone Mošnov

The Ostrava-Mošnov Strategic Industrial Zone is a unique environment for investors interested in taking advantage of the long-term renewal process taking place in industry and manufacturing in the region. The zone is situated 25 km south of the city centre and it is very accessible by road, railway and air. The zone is located next to Leoš Janáček Ostrava International Airport, whose runway can handle all types of aircraft including the latest Airbus A380. There is also a 30 hectare commercial-enterprise area in the immediate vicinity of the zone for small and medium-size enterprises. The site contains rental spaces suitable for administration purposes. An auxiliary energy supply is available at cost for investors in the zone.

**Investors located in the zone:**  
 Behr, Plakor, Cromodora Wheels, HB Reavis Group

Region	Students	Graduates	Programmes	Schools
Moravia-Silesia	38,635	8,562	717	106

**Selected companies in the district, ranked by turnover:**  
 ArcelorMittal Tubular Products Ostrava, Ostrava - Kunčice/Manufacture of tubes, pipes, hollow profiles and related fittings  
 Vitkovice Heavy Machinery, a.s., Ostrava - Vitkovice/Manufacture of engines and turbines, except aircraft, vehicle and motorcycle engines  
 Continental Automotive Systems, Frenštát pod Radhoštěm/Manufacture of other parts and accessories for motor vehicles  
 Tatra, a.s., Kopřivnice/Manufacture of motor vehicles  
 BrsodChem Mchz, s.r.o., Ostrava - Mariánské Hory/Manufacture of other organic basic chemicals  
 ODS-Dopravní stavby Ostrava, a.s., Ostrava - Jih - Zábřeh/Construction of bridges and tunnels  
 VVT - Vitkovice Válcovna Trub, a.s., Ostrava - Vitkovice/Manufacture of steel tubes, pipes, hollow profiles and related fittings  
 Semperflex Optimit, s.r.o., Odry/Manufacture of other rubber products  
 Dura Automotive Systems CZ, s.r.o., Kopřivnice - Vičovice/Manufacture of other parts and accessories for motor vehicles  
 Vitkovice Revmont, a.s., Ostrava - Radvanice/Manufacture of engines and turbines, except aircraft, vehicle and motorcycle engines

Source: CreditInfo, Company Monitor, 2010

## Strategic Industrial Zone Holešov

The Holešov Strategic Industrial Zone is being established on the site of a former intrastate public airport, which is being decommissioned, and on adjacent plots. The zone offers excellent road and railway access and links to motorways. Near the town of Hulín, which is only a few kilometers away, a new three-road intersection will be finished in 2010. The high-capacity D1, R55 and R49 motorways designed to carry fast motor traffic will meet at this new junction. The zone will be linked directly to the R49 motorway, which will run along the southern boundary of the zone. Construction of new a technology park in the Holešov Strategic Industrial Zone began in 2010. This technology park will provide favorable conditions for innovative companies with research and development potential. The park will also offer space for start-up companies.

**Investors located in the zone:**  
 Pokart, Kart Zlín, MRB Sazovice, Foundry and Machining, Holešov Technology Park

Region	Students	Graduates	Programmes	Schools
Zlín	18,917	4,776	329	58

**Selected companies in the district, ranked by turnover:**  
 Barum Continental, s.r.o., Otrokovice/Manufacture of rubber tyres and tubes; retreading and reconditioning of rubber tyres  
 Continental HT Tyres, s.r.o., Otrokovice/Manufacture of rubber tyres and tubes; retreading and reconditioning of rubber tyres  
 Deza, a.s., Valašské Meziříčí - Krásno nad Bečvou/Manufacture of other organic basic chemicals  
 Schott Solar CR, s.r.o., Valašské Meziříčí - Krásno nad Bečvou/Manufacture of electronic components  
 Fatra, a.s., Napajedla/Manufacture of plastic products  
 Woco STV, s.r.o., Vsetín/Manufacture of other parts and accessories for motor vehicles  
 Lindab-Astron s.r.o., Přerov I - Město/Manufacture of metal structures and parts of structures  
 PSP Engineering, a.s., Přerov I - Město/Manufacture of machinery for mining, quarrying and construction  
 Slovácké strojírní, a.s., Uherský Brod/Manufacture of lifting and handling equipment  
 CS CABOT, spol. s r.o., Valašské Meziříčí - Krásno nad Bečvou/Manufacture of other inorganic basic chemicals

Source: CreditInfo, Company Monitor, 2010